

■ **WEATHERPROOF (VVP)**

- Weatherproof IP65
- Robust chassis and housing
- Energy efficient lighting solution
- Suitable for external and high humidity applications

Internal View

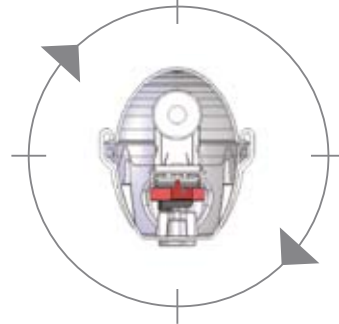

Available from:

|| See technical specifications overleaf >>>

WEATHERPROOF (WP)

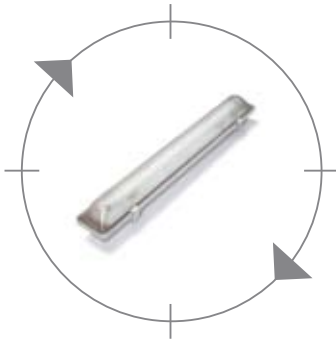

The WEATHERPROOF light has been designed based upon our own range of high quality batten lights to give you a highly energy efficient lighting solution for both external use and high humidity applications. The weatherproof casing which houses the light unit is mounted from tough GRP (Glass Reinforced Plastic) for robustness and also incorporates a rubber seal for water tightness. With the chassis in position and wiring connected, the clear polycarbonate lens is positioned over the lamp and secured with strong clamps along each edge giving it a watertight seal. The chassis is built from strong lightweight aluminium and is finished in white paint which gives a corrosion proof finish. The high efficiency inverter is mounted neatly inside the chassis and is enclosed with a high temperature heat-shrink sleeve for added protection.

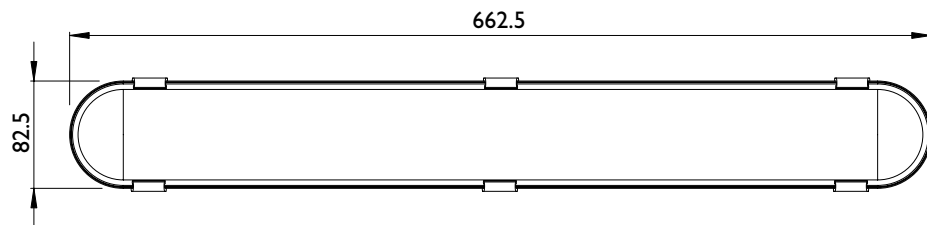
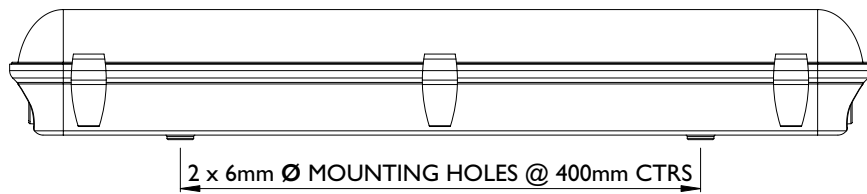
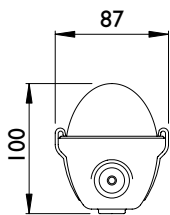

SPECIFICATION

ALL DIMENSIONS HAVE A TOLERANCE OF +/- 1mm

WEATHERPROOF (WP)

Model No		WPI8	WPI8/2
Supply Voltage	Vdc	12	24
Voltage Range	Vdc	10 to 15	20 to 32
Average Current	A	1.8	0.9
Crest Factor		1.6	1.6
Frequency	KHz	25	25
Tube Watts	W	18W	18W
Lumens	Lm	1100	1100
Weight	Kg	1.22	1.22
Temp' Range	°C	-10 to +40	-10 to +40